



22000 Industrial Blvd, Rogers, MN 55374
866-527-7637
www.motoalliance.com

DENALI Plow Mount MA11790 John Deere Gator XUV 625i/825i

Thank you for purchasing a DENALI plow mount. You now own a premium, custom plow mount to allow you to use your plow with your UTV/SxS. Please note the following instructions and heed all warnings.

- Your UTV/SxS and plow system can cause death or injury. Please use caution and common sense when operating your unit.
- Read your Plow Operator Manual, your Winch Operator Manual, and all warning labels before operating your UTV/SxS.
- Operate your UTV/SxS at a walking speed with the blade installed. Do not exceed 5 mph (8 km/h) even with the blade up.
- Do not operate the UTV/SxS on slopes greater than 10 degrees with the plow installed.
- Always lower the plow to the down position before leaving your UTV/SxS unattended.

SEVERE INJURY OR DEATH MAY RESULT IF YOU ARE NEGLIGENT.

Please verify that all hardware and parts are included in your package.

**DENALI John Deere Gator XUV 625i/825i
MA11790**

Kit Contents:

Part #	Qty	Description
1	1	MA11790 Plow Mount
2	4	M10 x 35mm 8.8 Bolts
3	4	M10 Flat Washer
4	4	M10 Nylock Nut

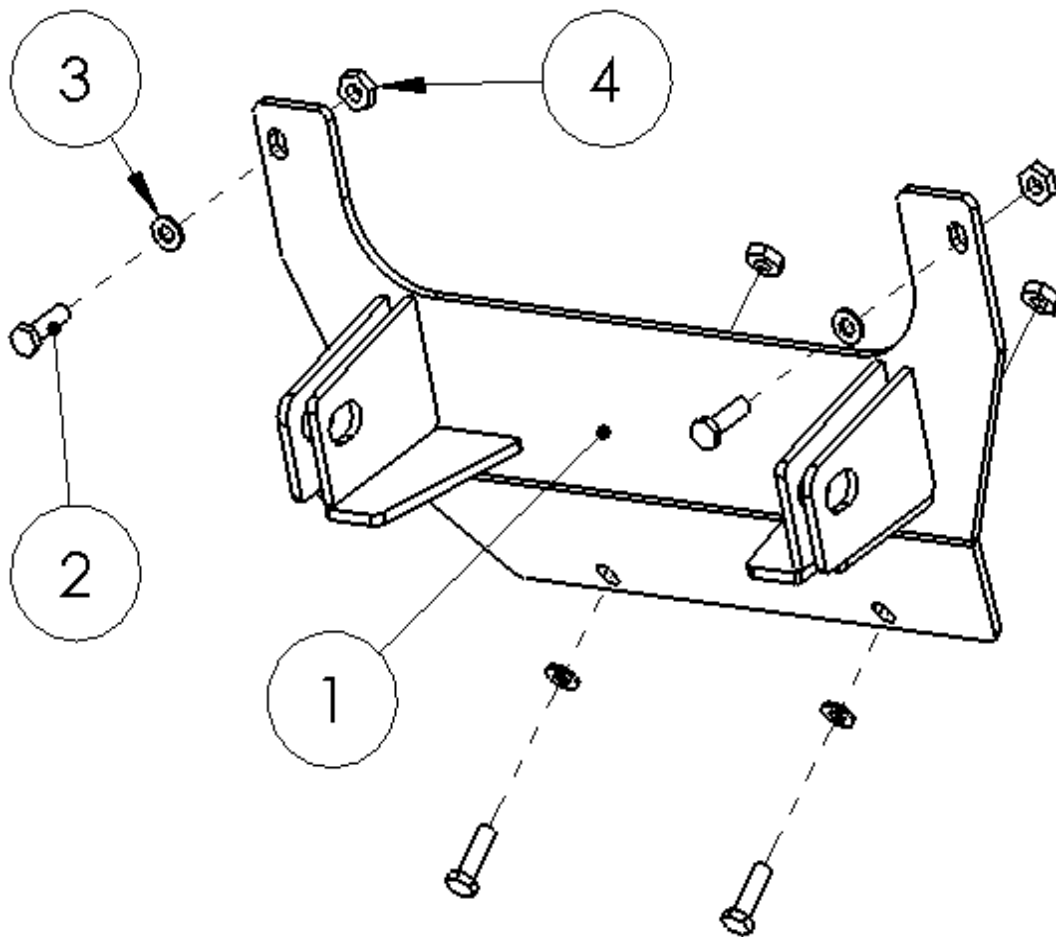

Figure 1

Installation Instructions

1. Your plow mount will attach over the metal factory brush guard. Start by removing the two bolts on the outside of the front bumper. Hold the plow mount up to the machine, as shown in Figure 2, and insert two of the included M10 x 35 bolts, washers, and nylock nuts. Do not tighten the bolts at this time.



Figure 2

2. Secure the bottom of the mount to the frame using the other pair of M10 bolts, washers and nylock nuts, as shown in Figure 3. Tighten the bolts to no more than 29 ft-lbs of torque.



Figure 3

**DENALI John Deere Gator XUV 625i/825i
MA11790**



motoalliance

22000 Industrial Blvd
Rogers, MN 55374
866.527.7637

3. Ensure that all hardware is tightened and attach the plow using the quick release pins included with DENALI Plow Kits.

